

PLOT OF LAND IN GARRIGUELLA

This land for sale in Garriguella, located in the Vent de l'Empordà Urbanization, offers a unique opportunity to build the house of your dreams in an idyllic environment. With an area of 1001 m², the plot is described in the deeds as an "urban plot intended for building." Although the City Council does not currently grant building permits in the area until the development is completed, there are already several houses built in it.

The strategic location of the land provides captivating views of the town of Garriguella and the Plà de Empordà. Imagine waking up every day to the fresh breeze and enjoying the panoramic views that this terrain has to offer. In addition to its attractive landscape, the plot is located in an area of high value and constantly growing.

Garriguella is a charming town full of history, with cobblestone streets and stone houses that give it a special charm. The tranquil environment and peace it offers are away from the hustle and bustle of the city, but at the same time, all the services and amenities are at your fingertips.

The Plà de Empordà, with its stunning landscape of green hills and vineyards, serves as the perfect backdrop for this terrain. Nature lovers will enjoy unparalleled walks and will be surrounded by natural beauty in its purest state. In addition, the local cuisine stands out as an additional attraction, allowing you to delight your palate with the exquisite Mediterranean flavors of the area.

In short, this land in Garriguella offers not only the opportunity to build the house of your dreams, but also to live in a charming place, full of history and surrounded by the serenity of nature.

Transaction Category	Sale Plot
----------------------	-----------

49.000 €





**CONSULTA DESCRIPTIVA Y GRÁFICA
DE DATOS CATASTRALES DE BIEN INMUEBLE**

Referencia catastral: 5778704EG0857N0001FH

DATOS DESCRIPTIVOS DEL INMUEBLE

Localización:
UR VENT D'EMPORDA. Suelo
17780 GARRIGUELLA (GIRONA)

Clase: URBANO
Uso principal: Suelo sin edif.
Superficie construida:
Año construcción:

PARCELA

Superficie gráfica: 938 m²
Participación del inmueble: 100,00 %
Tipo:

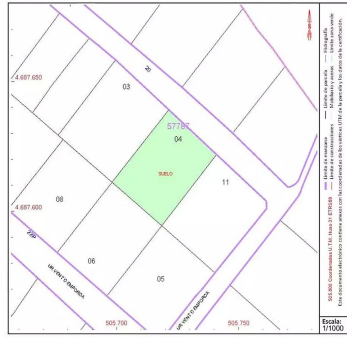

Este documento no es una certificación catastral, pero sus datos pueden ser verificados a través del "Acceso a datos catastrales no protegidos de la SEC".

Jueves, 1 de Febrero de 2024

